



**UC52/UC70**

**Extractors**

**Manual for Installation, Use and Maintenance**

## Important

SIA cannot be held responsible for injuries or losses caused by incorrect use or installation of this product. Please note that SIA reserves the right to invalidate the guarantee supplied with this product following incorrect installation or misuse of the appliance or use in a commercial environment.

This appliance is not designed to be used by people (including children) with reduced physical, sensorial or mental capacity, or who lack experience or knowledge about it, unless they have had supervision or instructions on how to use the appliance by someone who is responsible for their safety.

Under no circumstances should any external covers be removed for servicing or maintenance except by suitably qualified personnel.

### Appliance information:

Please enter the details on the appliance rating plate below for reference, to assist SIA Customer Care in the event of a fault with your appliance and to register your appliance for guarantee purposes.

Appliance Model

Serial Number

### CE Declarations of Conformity:

This appliance has been manufactured to the strictest standards and complies with all applicable legislation, including Gas safety, Electrical safety (LVD) and Electromagnetic interference compatibility (EMC).

### IMPORTANT INFORMATION FOR CORRECT DISPOSAL OF THE PRODUCT IN ACCORDANCE WITH EC DIRECTIVE 2002/96/EC.

At the end of its working life, the product must be taken to a special local authority waste collection centre or to a dealer providing appliance recycling services.

Disposing of a household appliance separately avoids possible negative consequences for the environment and health. It also enables the constituent materials to be recovered, saving both energy and resources. As a reminder of the need to dispose of household appliances separately, the product is marked with a crossed-out wheeled dustbin.



### Please note:

- Under no circumstances should the extractor be connected to any gas ventilation system, flue system or hot air ducting system.
- Do not vent the extractor into an attic or loft space.
- Only house the extractor in rooms with adequate ventilation. Remember that the extractor is powerful and whatever air is extracted needs to be replaced.
- Do not tile the extractor in. It should be removable for service or maintenance.
- Do not use silicone sealant to secure the hood to the wall.
- You must be able to isolate the extractor from the mains electrical supply after installation.
- This extractor has been designed to be used in a room with a volume of less than 36 m<sup>3</sup>.
- Steam cleaners must not be used when cleaning this appliance.
- The performance of your extractor will vary depending on a number of factors. These include: type of extraction, length of ducting, room volume, ventilation available and cleanliness of the filters.

## Using your Extractor

For best performance, you should switch on the extractor 15 minutes before starting to cook and leave it to run for approximately 15 minutes after the end of cooking.

### Control Panel

- A – Light switch
- B – Power switch
- C – Speed levels

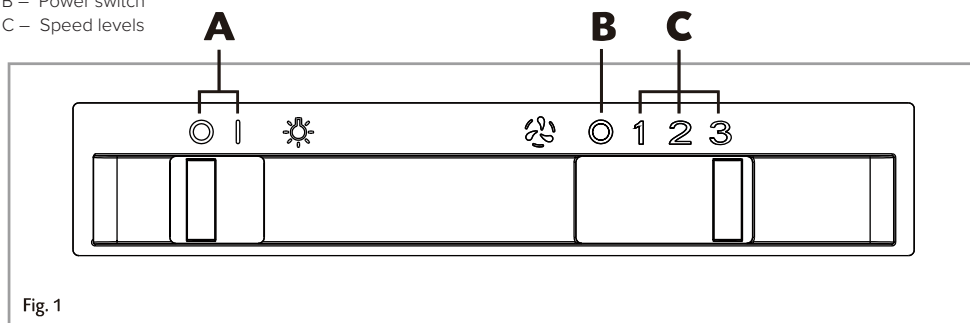

Fig. 1

### To switch the extractor light on or off

- Slide the light switch (A) to operate the light.

### To switch on the extractor or to change the speed at any time when the extractor is running

- Slide the power switch to the required position depending on the speed you require.

### To switch the extractor off

- Slide the power switch to position (B) on the control panel.

## Care and Maintenance

**IMPORTANT: DO NOT PERFORM MAINTENANCE OR CLEANING OF THE EXTRACTOR WITHOUT FIRST SWITCHING OFF THE ELECTRICITY SUPPLY.**

### Cleaning

You should use a non-abrasive cleaner. Any abrasive cleaner (including Cif) will scratch the surface and could erase the control panel markings.

You can clean you extractor effectively by simply using a dilute solution of water and mild detergent and drying to a shine with a clean cloth.

### Cleaning the grease filter

The grease filter should be kept clean to minimize the risk of fire.

At least once a month the grease filters should be removed and cleaned with warm soapy water. You can also wash the grease filters in a dishwasher, ensuring that the filters are put in an upright position to prevent damage from other items in the dishwasher. After rinsing and drying, replace the filter.

To remove the grease filter, push in the button on the handle and then pull down on the filter at the front. When you have released it at the front, then you can pull out the filter. To replace the grease filter, repeat the steps in reverse.

### Please note:

Cleaning the grease filter in the dishwasher may lead to discolouration. This is normal and does not constitute a fault with the appliance.

### Please note:

The extractor must not be used without the grease filter in place.

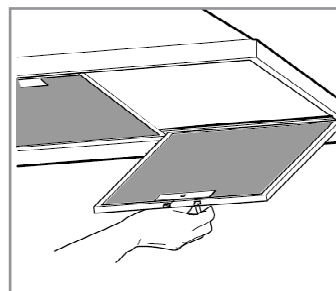

## Charcoal filter

In re-circulating mode, air is vented back into the kitchen through the opening in the cooker hood.

This method is advised if you are not using your hob intensively. Re-circulated air requires the use of charcoal filters to remove odours.

To ensure the best performance from your cooker hood, the charcoal filter should be replaced every 3-6 months, dependent on use.

**Note:** This charcoal filter is non-washable and must be replaced as required.

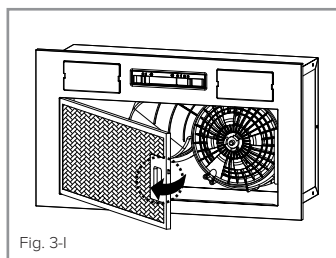

Fig. 3-I

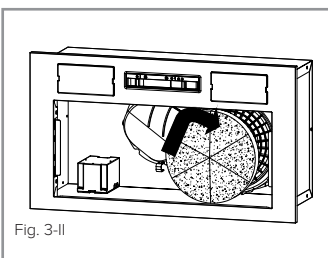

Fig. 3-II

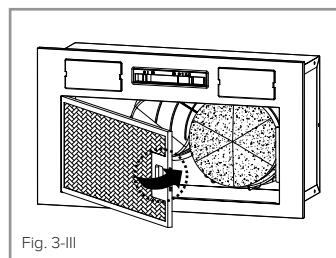

Fig. 3-III

To attach a new charcoal filter, follow the steps below:

- 1.Remove the grease filter (fig.3-I).
2. Place the charcoal filter on the centre of the motor support. Once firmly located, turn the charcoal filter clockwise 90 degrees until the filter locks into position(fig.3-II).
- 3.Replace the grease filter(fig.3-III)

## Changing the Light Bulb

**DO NOT CHANGE THE LIGHT BULB IMMEDIATELY AFTER USE AS THE BULB WILL BE HOT. ALLOW IT TO COOL BEFORE REMOVING IT.**

Remove the grease filter as previously described, unscrew the light bulb and replace it with the required bulb as shown in the table below. Finally, replace the grease filter.

UC52 UC70	 E14 LED 4Wx2 DR-4-H-E14-37
--------------	---

Table 1

Do not touch bulbs or adjacent areas during or straight after prolonged use of the lights.

The light is designed for use during cooking and not for general room illumination. Extended use of the light can reduce the life span of the bulb.

Bulb replacement is not covered by the guarantee.

Only use bulbs recommended for your extractor. Do not fit bulbs of a higher power rating. Bulbs of a lower power rating may be adequate for use, generally last longer and use less energy.

Spare bulbs are available from SIA Customer Care or from a local DIY shop.

## Mains Electricity Connection

**THIS APPLIANCE MUST BE CONNECTED TO THE MAINS SUPPLY BY A COMPETENT PERSON, USING FIXED WIRING VIA A DOUBLE POLE SWITCHED FUSED SPUR OUTLET AND PROTECTED BY A 3A FUSE.**

We recommend that the appliance is connected by a qualified electrician who is a member of the N.I.C.E.I.C. and who will comply with the I.E.E. and local regulations.

The wires in the mains lead of this appliance are coloured in accordance with the following code:

**BLUE = NEUTRAL, BROWN = LIVE.**

As the colours of the wires in the mains lead for the appliance may not correspond with the coloured markings identifying the terminals connecting to the fused spur, proceed as follows:

- The wire which is coloured blue must be connected to the terminal marked N (Neutral) or coloured black.
- The wire which is coloured brown must be connected to the terminal marked L (Live) or coloured red.

If the mains cable is damaged, it must be replaced by an approved engineer, service agent or similarly qualified person in order to avoid hazard.

**NOTE: USE A 3A FUSE**

Assembly and electrical connection should be carried out by competent personnel. When installing this product we recommend you seek the help of another individual.

**IMPORTANT: THIS APPLIANCE IS A CLASS II APPLIANCE (DOUBLE INSULATED) AND IS NOT INTENDED TO BE EARTHED. DO NOT FIT AN EARTH LEAD TO THIS EXTRACTOR.**

Do not mount the isolation switch behind any part of the appliance. It is a requirement that you must be able to isolate the extractor from the mains electrical supply after installation.

This appliance is intended to be connected to the mains electrical supply by means of an isolation switch and fused spur and is intended to be protected by a 3A fuse. The use of a 13A fuse can cause damage to the internal wiring in the event of a fault and may also invalidate the warranty.

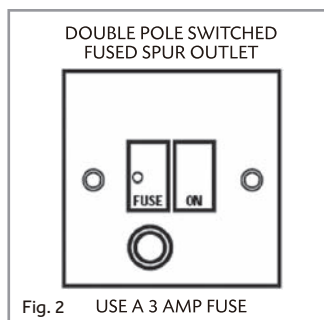

## Electrical Information

Mains electrical voltage: 230 – 240Vac.

Total rated power consumption: 48W.

## Troubleshooting

**If your extractor is not working:**

1. Check that the mains supply has not been switched off.
2. Check that the fuse in the spur has not blown.

## Installation

When the extractor is to be installed above an electric hob, the minimum distance between the hob and extractor must exceed 650mm.

When the extractor is to be installed above a gas hob, the minimum distance between the hob and extractor must exceed 750mm.

If the instructions provided with your gas hob state that the required distance between the hob and the extractor must be greater than 750mm, then that is the distance which should be observed. This is a legal requirement and may lead to your hob being disconnected from the gas supply and the installation reported to RIDDOR (the height should be measured from the top of the burners).

**IN THE ABSENCE OF ANY INSTRUCTIONS SUPPLIED WITH THE GAS HOB, THE MINIMUM DISTANCE BETWEEN THE HOB AND EXTRACTOR MUST BE AT LEAST 760mm.**

The width of any hob must not be greater than the width of the extractor installed above it.

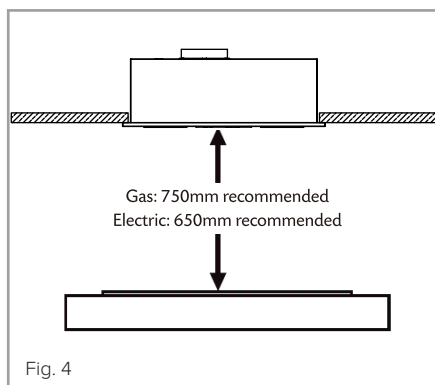

Extractor dimensions.

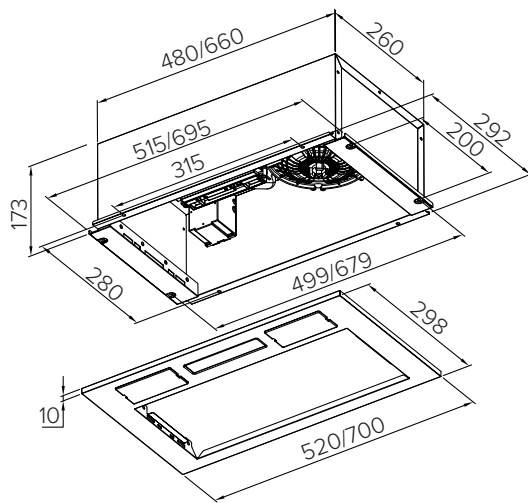

Fig. 5

## INSTALLATION

Mark out the dimensions of the cut-out based on your extractor.

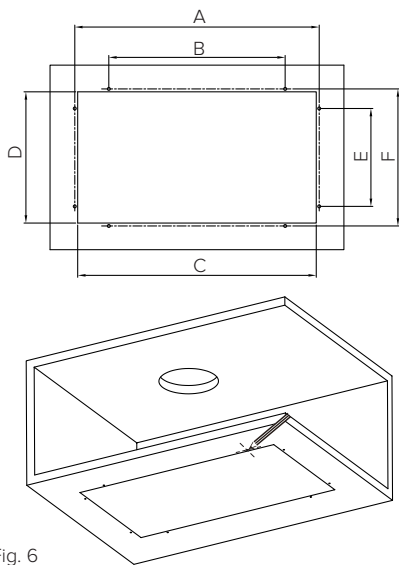

Fig. 6

	UC52	UC70
A	499	679
B	315	315
C	487	667
D	268	268
E	200	200
F	280	280



## INSTALLATION

Remove the grease filter, unscrew the 4 screws of the fixed panel and remove it.

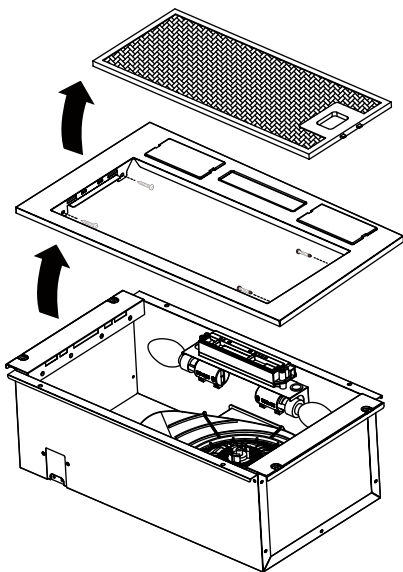

Fig. 7

Connect the exhaust pipe to the ducting adaptor and locate on the extractor as indicated.

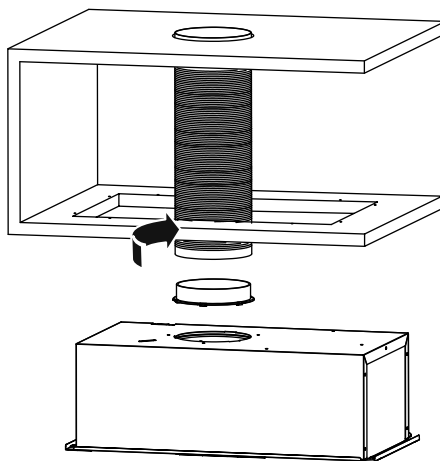

Fig. 8

Place the extractor into the cabinet opening and secure it with screws.

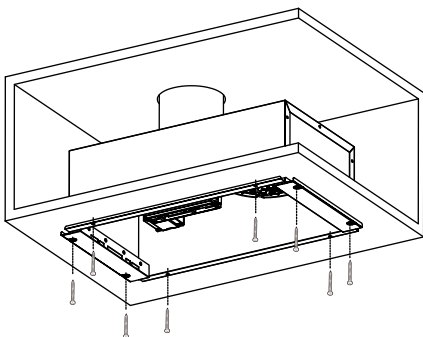

Fig. 9

Secure the panel on with the 4 previously removed screws (Fig 7) and insert the grease filter.

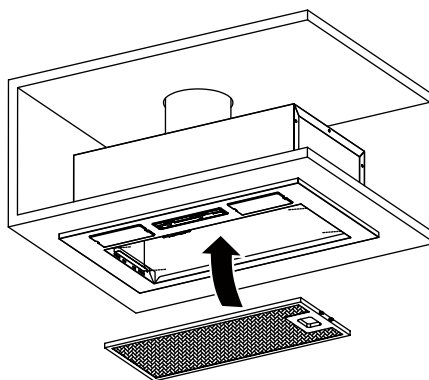

Fig. 10

## GUARANTEE

Your new product is guaranteed against defects in materials and/or workmanship. Any parts found to be defective will be repaired or replaced at our discretion. All repairs must be carried out by an authorised Repair Agent. Your extractor comes with a 5 years Parts 2 years Labour Guarantee.

### THIS GUARANTEE IS VALID PROVIDING THAT :

- The appliance has been installed by a suitably qualified person
- Installation has been carried out in accordance with the instructions and current legislation
- Proof of purchase can be produced
- The appliance has been used for domestic purposes only
- The appliance has not been tampered with, attempted to be repaired or modified by any unauthorised person

### THIS GUARANTEE DOES NOT COVER :

- Damage by misuse, neglect or transit
- Use of parts that have not been recommended
- Routine maintenance, general wear & tear and installation faults
- Rubber seals, removable glass and/or plastic parts, fuses or light bulbs which all need replacing periodically
- Second-hand or reconditioned appliances
- Appliances used for commercial or professional purposes

This guarantee does not in any way affect your statutory legal rights.

## Information and Advice

### CAUTION! Accessible parts may become hot when used with cooking appliances.

- There must be adequate ventilation of the room when the cooker hood is used at the same time as appliances burning gas or other fuels.
- Do not check the condition of the filters whilst the cooker hood is operating.
- Do not touch the light bulb within half an hour after the appliance has been used.
- Do not light a flame directly under the cooker hood.
- Avoid lighting the hob when there is no pan on the stove as this can damage the filters and cause a fire hazard.
- If the supply cord is damaged, it must be replaced by the manufacturer, its service agent or similarly qualified person in order to avoid a hazard.
- This extractor is intended to be installed over a hob with a maximum of 4 elements/burners.
- There is a fire risk if cleaning is not carried out in accordance with the instructions.

### Energy Efficiency Information

Attribute	Symbol	Value	Units
Model Identification		UC52 UC70	
Annual Energy Consumption	$AEC_{Hood}$	29.4	kWh
Time Increase factor	f	1.7	
Fluid Dynamic Efficiency	$FDE_{Hood}$	9.4	
Energy Efficiency Index	$EEI_{Hood}$	72.4 (C)	
Measured Pressure at Best Efficiency Point	$P_{BEP}$	136	Pa
Measured Electric Power at Best Efficiency Point	$W_{BEP}$	38.0	W
Nominal Lighting Power	WL	8.0	W
Average Illumination of the lighting system on the cooking surface	$E_{Middle}$	84	Lux
Measured Power Consumption in standby	$P_s$	N/A	W
Measured Power Consumption off mode	$P_o$	0.0	W
Noise level	$L_{WA}$	63	dBA
Grease Filter Efficiency	$GFE_{Hood}$	49.1 (F)	%
Lamp Efficiency	$LE_{Hood}$	10 (E)	%

E & O E. All instructions, dimensions and illustrations are provided for guidance only. SIA reserve the right to change specifications without prior notice.



Please call for Service,  
contact number: 01623 625 658  
[customer.care@shipitappliances.com](mailto:customer.care@shipitappliances.com)

Ship It Appliances  
Unit A, Concorde Way  
Millennium Business Park  
Mansfield  
Nottinghamshire  
NG19 7JZ